

LIFTEK

DRIVERTRUCK10 PLUG-IN

SEMI-ELECTRIC
PALLET TRUCK

2000 KG

PRODUCT CODE

HGEPSE18EHJ



- ☑ Small turning radius and lightweight design for ultra-narrow channel operation.
- ☑ Enclosed oil pipeline and line in the truck body for safety and easy maintenance.
- ☑ Combines key switch and electric meter for simple and easy operation.
- ☑ Front baffle and battery are easy to disassemble and replace.
- ☑ Standard emergency stop switch and emergency reverse device for safety.
- ☑ Power-off braking activates when the handle is released or fully pressed.
- ☑ Uses both electromagnetic and motor braking for enhanced driver safety.
- ☑ Standard built-in charging system for convenience.

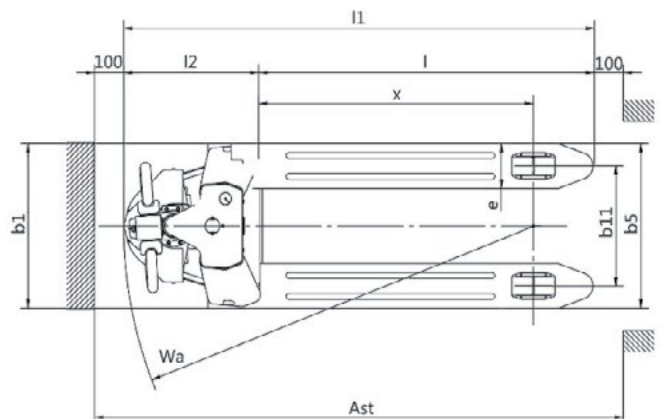
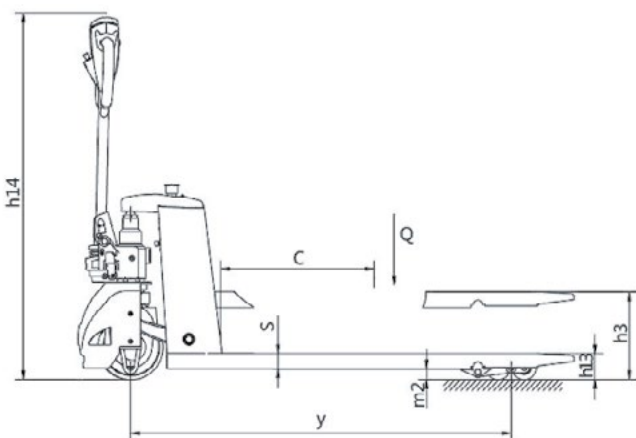

SEE TABLE OVER FOR IMAGE DATA

SHS
HANDLING SOLUTIONS

☎ 0800 619 0800
✉ SALES@SHS-HANDLING.COM

SHSHANDLING
SOLUTIONS
.COM

📍 SHS HANDLING SOLUTIONS LTD, ELEVATION HOUSE, UNIT G1-G3, BOROUGH ROAD, BUCKINGHAM INDUSTRIAL ESTATE, BRACKLEY, NN13 7BE

MANUFACTURER'S DATA AND DESIGN CHARACTERISTICS

Characteristics		
Manufacturer		LIFTEK
Model		DriverTruck 10 Plug-In
Type of Operation		Pedestrian
Load Capacity	Q(kg)	2000
Lift Height	h3(mm)	200
Service Weight with Battery	kg	155
Load Centre	c(mm)	600
Axel Centre to fork face	Ximm)	944
Wheel Base	y(mm)	1243
Controller		CURTIS
Wheel		
Wheels Type		Polyurethane
Driving Wheels Size	Φx w(mm)	Φ 210x70
Loading Wheels Size	Φx w(mm)	Φ 80x60
Wheels, Number Front/Rear (x=driven)		1x/4
Track Width, Rear, Loading Side	b11(mm)	400/535
Dimensions		
Overall Length	l1mm	1620
Length to Fork Face	l2(mm)	470
Overall Width	b1(mm)	560/685
Fork Dimensions	s/el(mm)	50/150/1150
Width of Fork	b5(mm)	560/685
Lower Height	h13(mm)	85
Min. Ground Clearance	m2(mm)	35
Height Drawbar in Driving Position min. /max.	h14/mm)	720/1090
Aisle Width with Pallet 1000 × 1200 across forks	Ast(mm)	1825
Aisle Width with Pallet 800 × 1200 along forks	Astimm)	1875
Min. Turning Radius	Wa(mm)	1415
Performance		
Travel Speed, with/without load	km/h	4.2/4.5
Max. Gradeability laden/unladen	(%)	3/10
Service Brake Type		Electromagnetic Brake
Drive and Battery		
Drive motor, output s2 60 min.	kW	0.75
Lift Motor rating at s3 15%	kW	-
Battery According to din 43531/35/36 a,b,c, no		no
Batter Voltage/Rated Capacity	V/Ah	24/32
Battery Weight (± 5%)	kg	20.2
Charger Specification		24V/5A
Others		
Type of Drive Control		DC
Sound Pressure Level at Driver's Ear	dB(A)	≤70
Steering Typev		Mechanical Steering

AT SHS, WE HELP COMPANIES MOVE GOODS SAFELY AND EFFICIENTLY BY DESIGNING, SUPPLYING, AND MAINTAINING MATERIALS HANDLING EQUIPMENT.