

# LIFTEK

## ES16-RS

ELECTRIC STACKER  
**1600 KG**

PRODUCT CODE

LTS1430R



- ☑ High Strength Structure Suits High Racking Applications
- ☑ Various Options Such As Foldable Platform
- ☑ Protection Arm & Power Steering
- ☑ Side positioned drive system, easy to manage stability

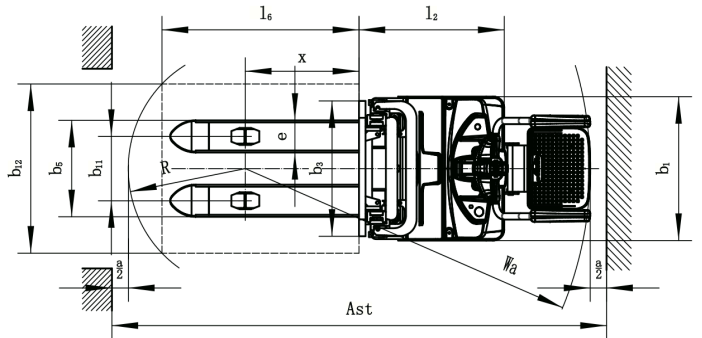
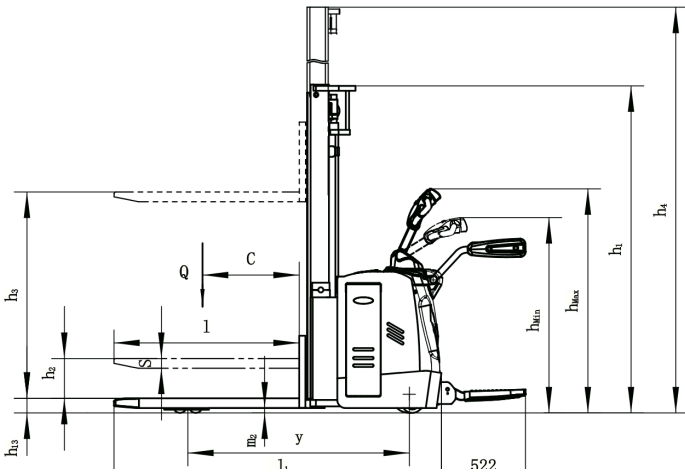

SEE TABLE OVER FOR IMAGE DATA



☎ 0800 619 0800

✉ SALES@SHS-HANDLING.COM



📍 SHS HANDLING SOLUTIONS LTD, ELEVATION HOUSE, UNIT G1-G3, BOROUGH ROAD, BUCKINGHAM INDUSTRIAL ESTATE, BRACKLEY, NN13 7BE

# MANUFACTURER'S DATA AND DESIGN CHARACTERISTICS

| <b>Characteristics</b>                           |          |                       |
|--|----------|-----------------------|
| Manufacturer                                     |          | LIFTEK                |
| Model  |          | ES16-RS               |
| Type of Operation                                |          | Standing              |
| Load Capacity                                    | Q(kg)    | 1600                  |
| Lift Height                                      | h3(mm)   | 2912                  |
| Service Weight with Battery                      | kg       | 1240                  |
| Load Centre                                      | c(mm)    | 600                   |
| Axel Centre to fork face                         | Ximm)    | 693                   |
| Wheel Base                                       | y(mm)    | 1375                  |
| Controller                                       |          |                       |
| <b>Wheel</b>                                     |          |                       |
| Wheels Type                                      |          | Polyurethane          |
| Driving Wheels Size                              | Φx w(mm) | Φ 230x75              |
| Loading Wheels Size                              | Φx w(mm) | Φ 85x70               |
| Wheels, Number Front/Rear (x=driven)             |          | 1x+1/4                |
| Track Width, Rear, Loading Side                  | b11(mm)  | 380/495               |
| <b>Dimensions</b>                                |          |                       |
| Overall Length                                   | l1mm     | 2035                  |
| Length to Fork Face                              | l2(mm)   | 884                   |
| Overall Width                                    | b1(mm)   | 850                   |
| Fork Dimensions                                  | s/el(mm) | 60/190/1150           |
| Width of Fork                                    | b5(mm)   | 570/685               |
| Lower Height                                     | h13(mm)  | 88                    |
| Min. Ground Clearance                            | m2(mm)   | 28                    |
| Height Drawbar in Driving Position min. /max.    | h14(mm)  | 1150/1480             |
| Aisle Width with Pallet 1000 x 1200 across forks | Ast(mm)  | 2605/2965             |
| Aisle Width with Pallet 800 x 1200 along forks   | Astimm)  | 2575/2935             |
| Min. Turning Radius                              | Wa(mm)   | 1730/2090             |
| <b>Performance</b>                               |          |                       |
| Travel Speed, with/without load                  | km/h     | 5.5/6.0               |
| Max. Gradeability laden/unladen                  | (%)      | 8/16                  |
| Service Brake Type                               |          | Electromagnetic Brake |
| <b>Drive and Battery</b>                         |          |                       |
| Drive motor, output s2 60 min.                   | kW       | 1.6                   |
| Lift Motor rating at s3 15%                      | kW       | 3.0                   |
| Battery According to din 43531/35/36 a,b,c, no   |          |                       |
| Batter Voltage/Rated Capacity                    | V/Ah     | 24/210                |
| Battery Weight (± 5%)                            | kg       | 200                   |
| Charger Specification                            |          |                       |
| <b>Others</b>                                    |          |                       |
| Type of Drive Control                            |          | AC                    |
| Sound Pressure Level at Driver's Ear             | dB(A)    | 74                    |
| Steering Type                                    |          | Electronic Steering   |

AT SHS, WE HELP COMPANIES MOVE GOODS SAFELY AND EFFICIENTLY BY DESIGNING, SUPPLYING, AND MAINTAINING MATERIALS HANDLING EQUIPMENT.



0800 619 0800  
SALES@SHS-HANDLING.COM

SHSHANDLING  
SOLUTIONS  
.COM

SHS HANDLING SOLUTIONS LTD, ELEVATION HOUSE, UNIT G1-G3, BOROUGH ROAD, BUCKINGHAM INDUSTRIAL ESTATE, BRACKLEY, NN13 7BE